



CHARLES BARTLETT
RESIDENTIAL



6 Meteor Row

Grove, Wantage, OX12 0PG

Guide price £425,000

An immaculately presented four-bedroom detached family home offering spacious open-plan living, driveway parking, garage and a beautifully landscaped rear garden, situated within one of Grove's most popular modern developments.

This stylish and contemporary home is perfectly suited to modern family life, with generous room sizes throughout and a superb open-plan kitchen/dining space forming the heart of the property. The kitchen is fitted with integrated appliances and provides ample space for both entertaining and everyday living, accessible WC and French doors opening directly onto the rear garden creating excellent indoor-outdoor living during the warmer months.

To the front of the property, the separate sitting room offers a cosy retreat away from the main living space, ideal for relaxing evenings or family movie nights.

Upstairs, the property continues to impress with four genuine double bedrooms, including a spacious master bedroom with en-suite shower room. The remaining bedrooms are served by a modern family bathroom, making the layout ideal for growing families, home working or visiting guests.

Externally, the landscaped rear garden enjoys an extended patio area ideal for outdoor dining and entertaining, alongside a lawned garden offering plenty of space for children or pets. To the front is driveway parking for multiple vehicles leading to the integral garage.

- Immaculately presented detached family home
- Four double bedrooms
- Spacious open-plan kitchen/dining room
- Separate living room
- Master bedroom with en-suite
- Driveway parking & integral garage
- Popular modern development
- Excellent access to A34 & Didcot Parkway
- EPC Rating B

Viewing

Please contact our Charles Bartlett Residential Office on 07939 496551

if you wish to arrange a viewing appointment for this property or require further information



Floor Plan

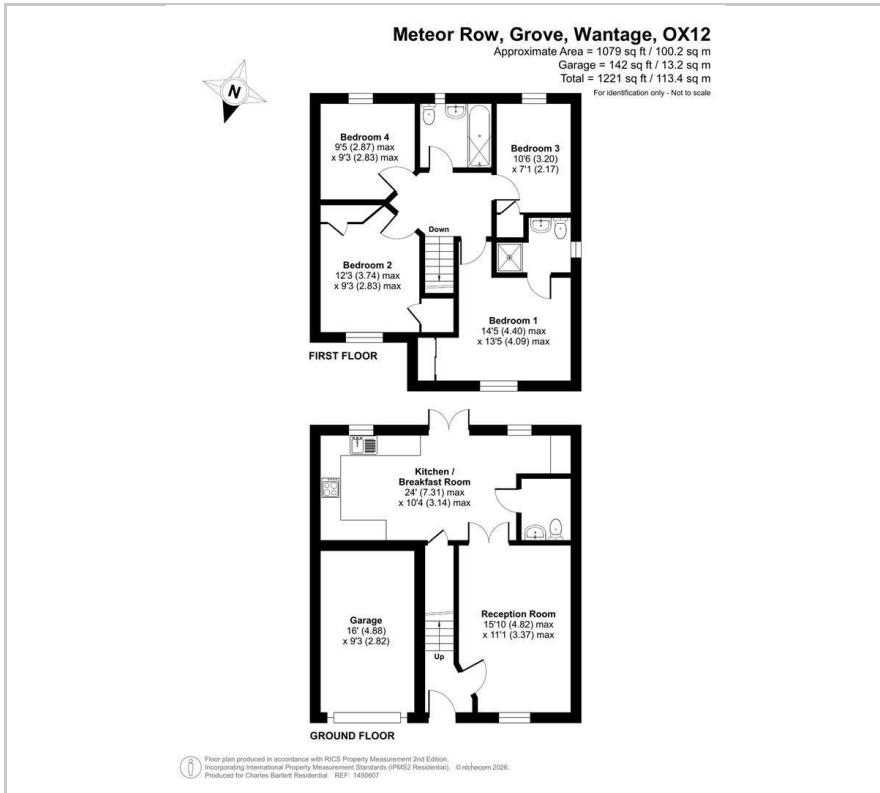

Area Map



Energy Efficiency Graph

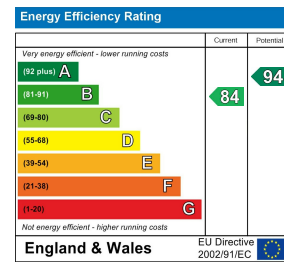

These particulars, whilst believed to be accurate are set out as a general outline only for guidance and do not constitute any part of an offer or contract. Intending purchasers should not rely on them as statements of representation of fact, but must satisfy themselves by inspection or otherwise as to their accuracy. No person in this firm's employment has the authority to make or give any representation or warranty in respect of the property.